

+levels shown are finished levels

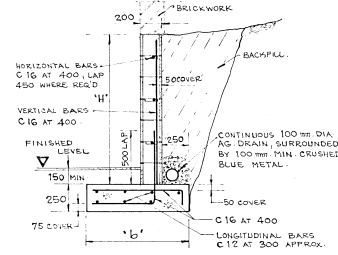
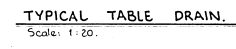
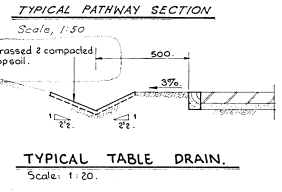
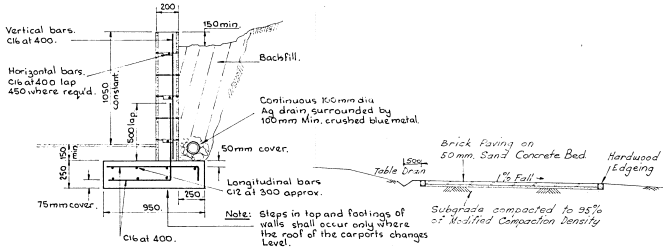

RETAINING WALL SCHEDULE

WALL HEIGHT 'H'	BASE 'b'
LESS THAN 1.0 m.	0.70 m.
1.0 TO 1.4 m.	0.95 m.
1.4 TO 1.8 m.	1.15 m.
1.8 TO 2.0 m.	1.30 m.

Note: For the remaining retaining walls RW17 - RW20 - RW22 - RW23 - RW24 - RW25 - RW27 - RW28 - RW29 - RW30 - RW31 - RW32 - RW34 - RW35 - RW39 height of wall varies, refer to Architects' drawings.

JOB NUMBER
75035

MASONRY NOTES:

- Place Class A strength 12 MPa concrete masonry units conforming to AS No. 407.
- Lay all walls true using best quality workmanship. **REINFORCED FACE SHELLS** in freshly prepared mortar uniformly mixed in ratio of one part cement, three parts sand, and one tenth part lime, conforming to A.S. No. 123.
- Fix deformed bar reinforcement conforming to A.S. No. A97-1958 except that 800 diameter ties or stirrups may be plain bars.
- Securely fix all inserts before pouring grout.
- Pour grout having a composition of one part cement three parts sand one tenth part lime and two parts aggregate pass 3/8" sieve, and enough water to flow freely without segregation.
- Stop all grout pours 10 below top of block.
- Sealing back of wall.
 - Sub in a composition of two parts sand, one part cement, as the wall is built.
 - Apply 2 coats of cement based paint in the proportions of one part "Plastic" six parts cement, five parts water.

Architects may replace lime wholly or partially if test indicate the strength requirements will be maintained and bond between surface will not be impaired.

DRAWING
3/10/75
PRINTED

A Retaining walls drafted. *[Signature]* 2/1/75

No. REVISION. APP'D DATE

ARCHITECTS:
MICHAEL DYSAERT & ASSOCIATES Pty Ltd.
85 George St. SYDNEY COVE. SYDNEY 2000. 241 2157.
PROJECT
URAMBI
COOPERATIVE COMMUNITY
ADVANCEMENT SOCIETY LTD
CROZIER CIRCUIT KAMBAH SEC 149 ACT
SHEET SUBJECT
PATHWAYS & RETAINING WALLS.

TAYLOR THOMSON WHITTING
Consulting Engineers, 48 Chandos Street, St. Leonards, N.S.W. 437 7253

DESIGN C.T. DRAWN D.C. DATE 15/10/75
 CHECKED *[Signature]* APPROVED *[Signature]*
 NUMBER IN SET 15 DRAWING NUMBER **75035/16**

0 10 20 30 40 50 60 70 80 90 100 110 120 130 140 150 160 170 180 190 200 MILLIMETRES

JOB NUMBER
75035

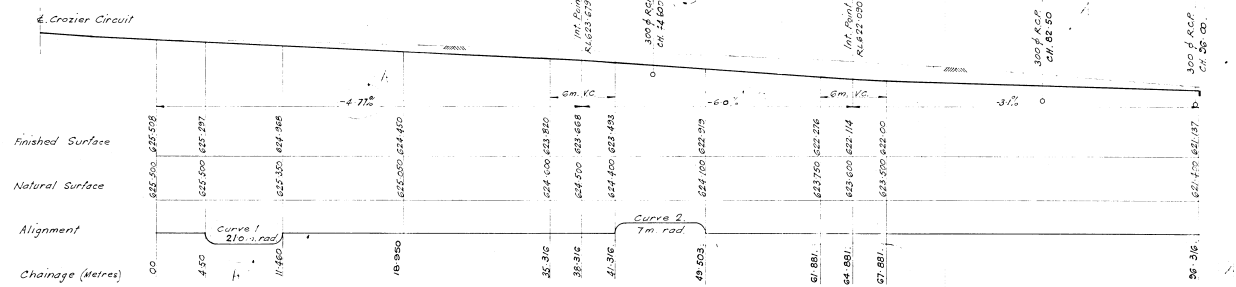

Scale:
Vertical 1:20
Horizontal 1:200

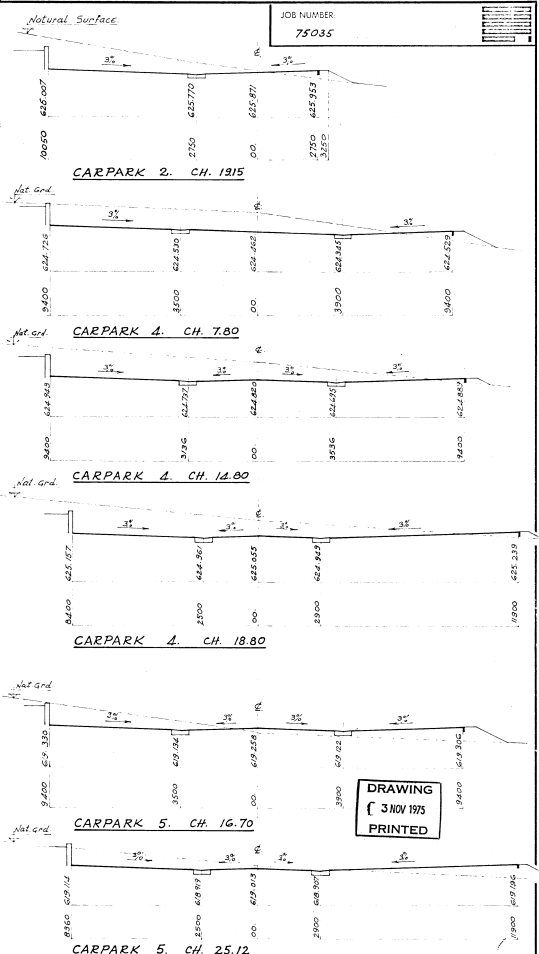
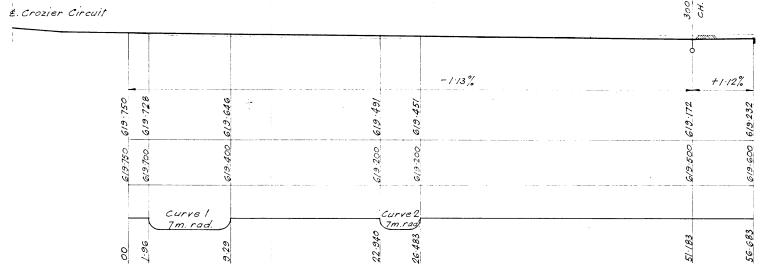
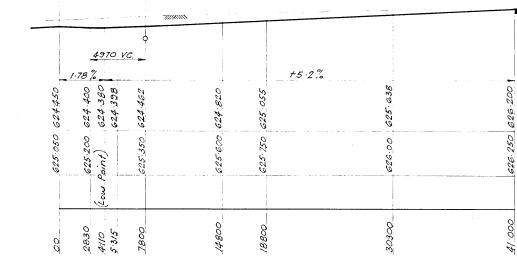

DRAWING
3 NOV 1995
PRINTED

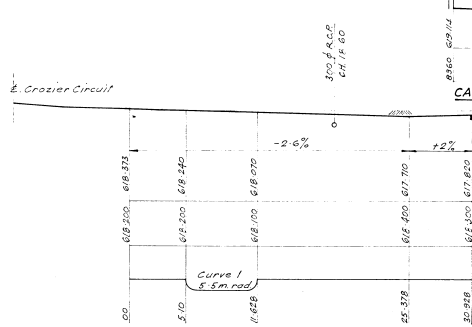
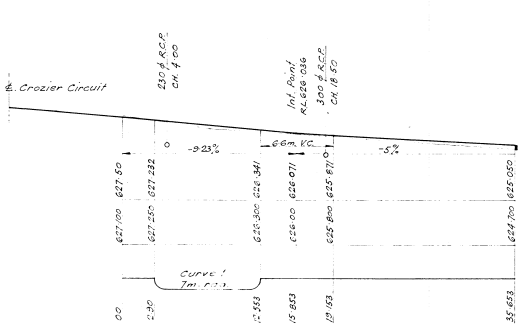
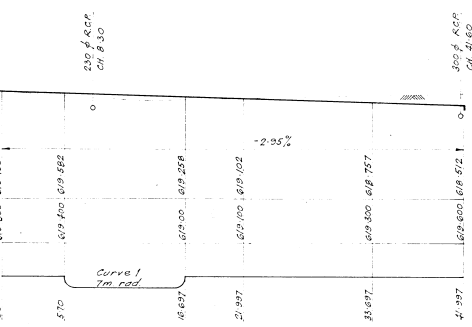

A. Access Rd & Carpark 1 chainage changed (11/3/95)		
No.	REVISION	APP'D DATE
ARCHITECTS: MICHAEL DYSART + ASSOCIATES Pty Ltd. 108 GREEN ST. SYDNEY COVE. SYDNEY 2000. 241-2157.		
PROJECT: URAMBI COOPERATIVE COMMUNITY ADVANCEMENT SOCIETY LTD. CROZIER CIRCUIT KAMBAH (SEC.149)ACT.		
SHEET SUBJECT		
ACCESS ROADS & CARPARKS LONGITUDINAL SECTIONS		
TAYLOR THOMSON WHITTING Consulting Engineers, 43 Chanda Street, St. Leonards, N.S.W. 437 7233		
DESIGN	C.T.	DRAWN
CHECKED	K.N.	DATE
NUMBER	APPROVED	3 Nov 95
IN SET	15	DRAWING NUMBER
		75035/5/A.

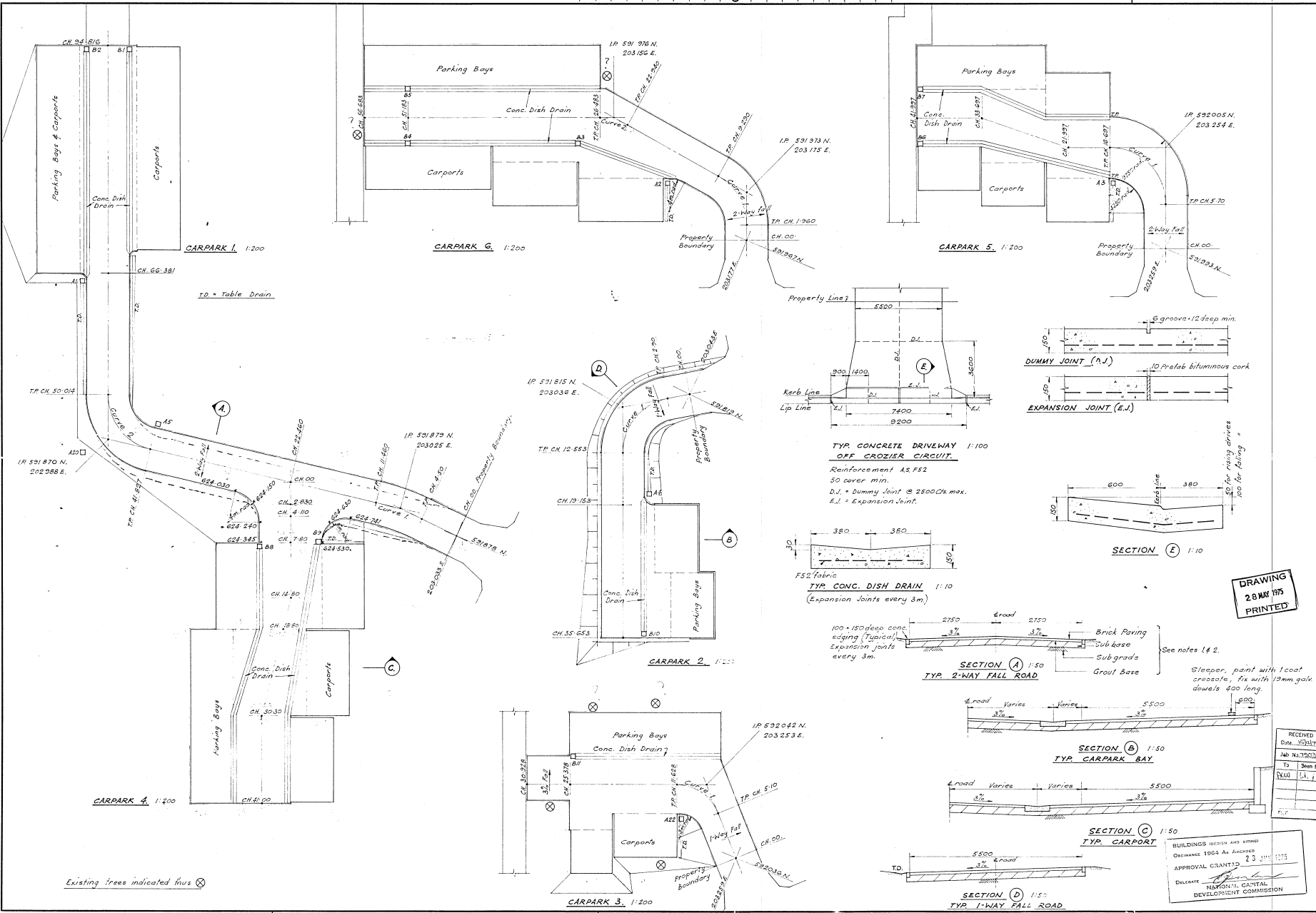

JOB NUMBER:
75035

NOTES
 1. Subgrade Granular Soils (c&g approx 15%)
 Subgrade compacted to 95% of Modified Compaction Density.
 Subbase - 150mm fine crushed rock compacted to 100% of M.C.D.

2. Subgrade Clay Soils (c&g 2-4%)
 Subgrade compacted to 95% of M.C.D.
 Subbase - 100mm select fill layer compacted to 95% of M.C.D. + 150mm fine crushed rock compacted to 100% of M.C.D.

3. Surface Course Brick Paving
 Select fill - granular silty/clayey sands from site.
 Contractor to check CBR values of subgrade soils before construction of pavement.
 For details of pits see drg.no.
 Min. grade of all table drains 1%.

DRAWING
 28 MAY 1975
 PRINTED

No.	REVISION.	APP'D. DATE.

ARCHITECTS
MICHAEL DYSART & ASSOCIATES Pte Ltd.
 03 George St. SYDNEY NSW (PHONE 2000 2111)

PROJECT
URAMBI
 COOPERATIVE COMMUNITY
 ADVANCEMENT SOCIETY LTD.
 CROZIER CIRCUIT KAMBAH (SECTION) ACT

SHEET SUBJECT
ACCESS ROADS & CARPARK LAYOUTS & DETAILS

TAYLOR THOMSON WHITTING
 Consulting Engineers, 48 Chandos Street, St. Leonards, NSW. 437 7283

DESIGN C.T.	DRAWN R.N.	DATE May 75
CHECKED	APPROVED	23 May 1975
NUMBER IN SET	DRAWING NUMBER	75035/4

RECEIVED
 Date 23/5/75
 By M.D.
 TO: Seen by
 K.L.D. J.A. 1
 P.L.P.

BUILDINGS DESIGN AND SURVEY
 EXCHANGE 1964 AN ANNECIS
 APPROVAL GRANTED 23 May 1975
 DELICATE NATIONAL CAPITAL DEVELOPMENT COMMISSION

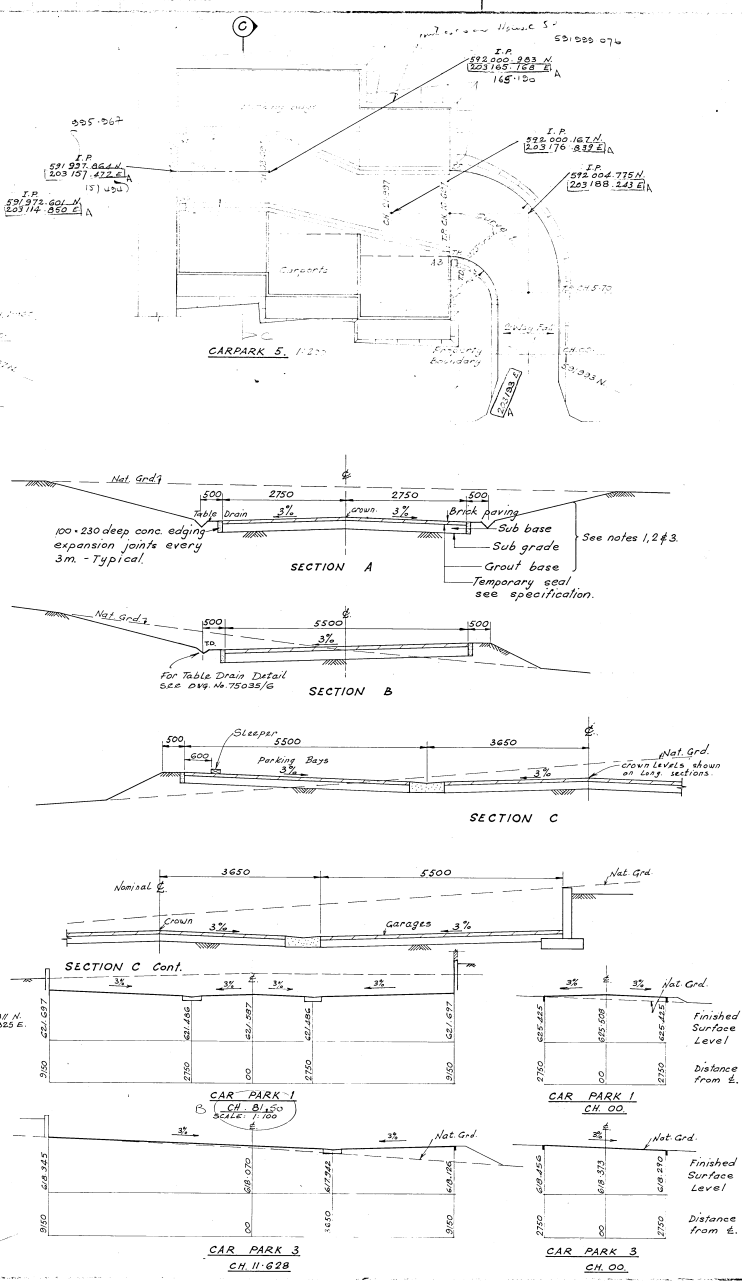
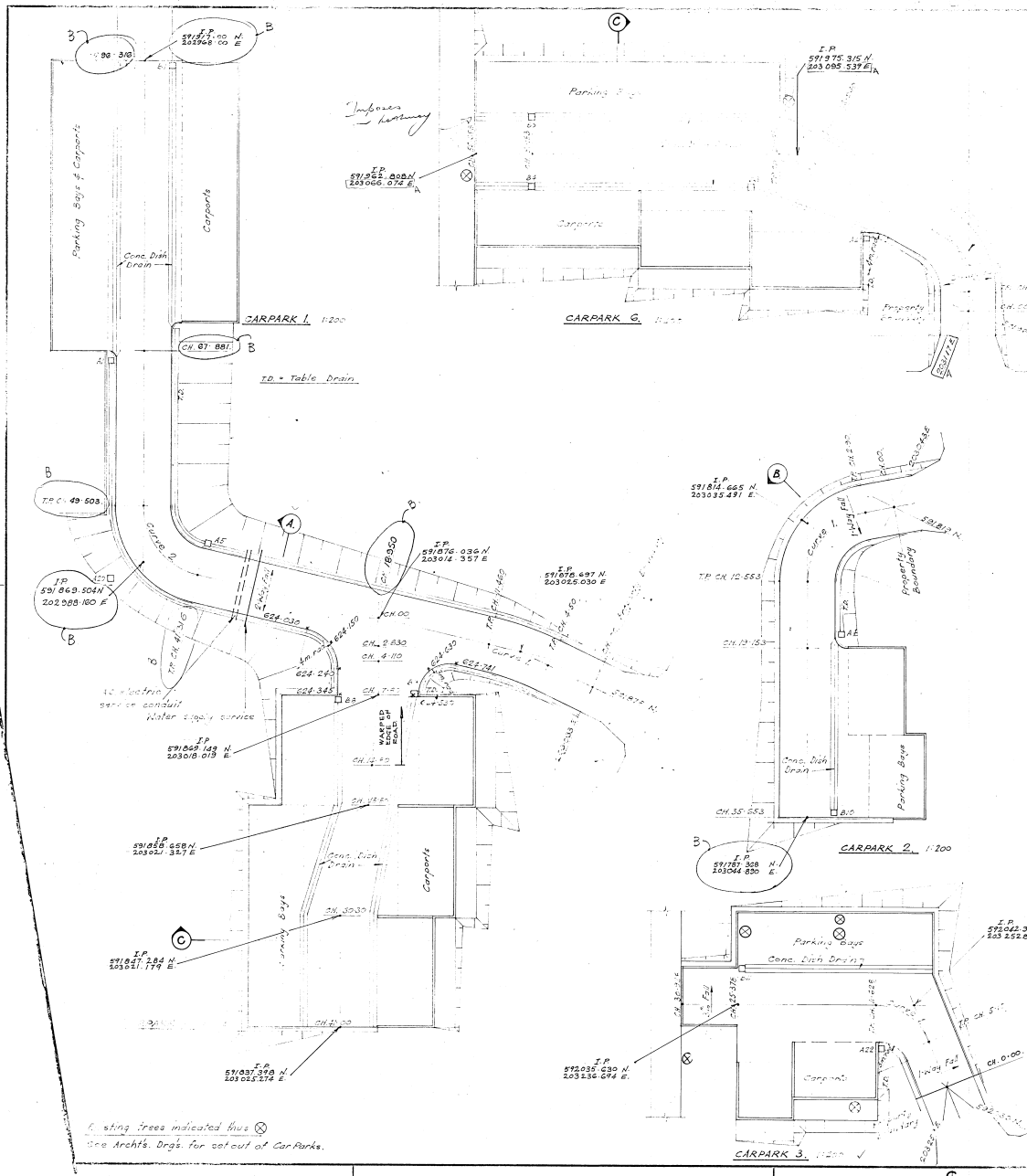

DRAWING
3 NOV 1975
PRINTED

- 1.2755
 1. Subgrade - Granular Soils (C.B.R. Approx. 15%)
 Subgrade compacted to 95% of Modified Compaction Density.
 Sub-base - 100mm thick crushed rock compacted to 100% of M.C.D.
 2. Subgrade - Clay Soils (C.B.R. 2-4%)
 Subgrade compacted to 95% of M.C.D.
 Sub-base - 100mm select fill layer compacted to 95% of M.C.D. + 100mm thick crushed rock compacted to 100% of M.C.D.
 3. Surface Course - Brick Paving on 50mm 1:3 cement sand mix placed beneath brick paving. Bedding interspaces of brick paving to be filled with granular silty/clayey sand from site.
 Contractor to check C.B.R. values of bedding soils before construction of pavement.
 For details of pits see drawing 15035-13
 Min. grade of all table drains 1%
 R. G. Mather
 APP'D DATE

REVISION: APP'D DATE

PREPARED BY: DANIEL DYSART + ASSOCIATES Pty Ltd
 15035-13
 SUBJECT: ACCESS ROADS & CARPARK LAYOUTS & DETAILS

URAMBI
 COOPERATIVE COMMUNITY
 MANAGEMENT SOCIETY LTD
 15035-13
 SUBJECT: ACCESS ROADS & CARPARK LAYOUTS & DETAILS

LAYLOR THOMSON WHITTING
 15035-13
 43 Chandos Street, St. Leonards, N.S.W. 4372

CHECKED BY: [Signature] APPROVED BY: [Signature] DATE: May 75
 NUMBER IN SET: 15 DRAWING NUMBER: 15035-13-B

1. Planting trees indicated thus ⊗
 See Archt's. Drawg. for set-out of CarParks.